

NOTICE!!

These documents have been scanned!

Do not place un-scanned documents beneath this notice!

Do not remove this notice from this file!

GPO Jacket No. 560-102
Print Order 61540
Rise Business Services, LLC
Job=AZ15 5/10/2019



Box Number= AZ15036



Claim Begin-End: AMC425399-AMC425399

1 Initial Receipt



AZ15036-16

AMC425096-AMC425592

United States Department of the Interior
Bureau of Land Management
 LANDS/RECREATION & PLANNING
 ONE N CENTRAL AVE
 PHOENIX, AZ 85004 -2203
 Phone: 602-417-9200

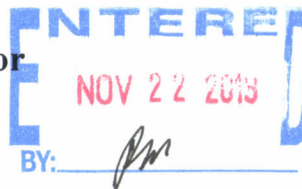

Receipt

No: 2908756

Transaction #: 2995485	
Date of Transaction: 11/12/2013	
CUSTOMER:	
CHRISTOPHER KELLER 911 S 17TH AVE PHOENIX,AZ 85007-3507 US	

LINE #	QTY	DESCRIPTION	REMARKS	UNIT PRICE	TOTAL
1	1.00	LOCATABLE MINERALS / MINING CLAIMS-NEW,UNADJUD, ONE OR MORE AUTH NOS / NEW MINING CLAIM LOCATION FEE \$34 CASES: AMC425399/\$34.00		- n/a -	34.00
2	1.00	LOCATABLE MINERALS / MINING CLAIMS-NEW,UNADJUD, ONE OR MORE AUTH NOS / NEW MINING CLAIM PROCESSING FEE \$20 CASES: AMC425399/\$20.00		- n/a -	20.00
3	1.00	LOCATABLE MINERALS / MINING CLAIMS-NEW,UNADJUD, ONE OR MORE AUTH NOS / NEW MINING CLAIM MAINT FEE \$140 CASES: AMC425399/\$140.00		- n/a -	140.00
TOTAL:					\$194.00

PAYMENT INFORMATION			
1	AMOUNT:	194.00	POSTMARKED: N/A
	TYPE:	CASH	RECEIVED: 11/12/2013
	NAME:	KELLER, CHRISTOPHER 911 S 17TH AVE PHOENIX AZ 85007-3507 US	

REMARKS

This receipt was generated by the automated BLM Collections and Billing System and is a paper representation of a portion of the official electronic record contained therein.

NOTICE!!

These documents have been scanned!

Do not place un-scanned documents beneath this notice!

Do not remove this notice from this file!

GPO Jacket No. 560-102
Print Order 61540
Rise Business Services, LLC
Job=AZ15 5/10/2019



Box Number= AZ15036



Claim Begin-End: AMC425399-AMC425399

2 Correspondence



AZ15036-16

AMC425096-AMC425592



File Code: 2810
Date: August 28, 2018

AMC 425399

Mr. Christopher Keller
908 S. 17th Ave #14
Phoenix, AZ 85007

RE: Campwood Mining Claim

Dear Mr. Keller

I have received your proposed Plan of Operations (Plan) dated August 1, 2018 regarding placer mining on your Campwood mining claim. Your Plan includes using a metal detector, small screens, gold pan, and shovel in Township 6 North, Range 5 East, Section 25. Your Plan meets criteria for a Notice of Intent (NOI) and has provided sufficient information to determine the extent of your operations and the scope of environmental disturbance associated with your proposal.

Per 36 CFR 228.4(a), I have determined that significant surface disturbance is not anticipated to result from your proposed activities as described. I acknowledge your NOI as described and no plan of operations or reclamation performance bond will be required; this is with the understanding that activities you described are confined to the wash and avoids wildlife and vegetation. If I have misunderstood your proposal or you need to amend the Plan, please contact Alex Mankin at the number below.

Activities are acknowledged to occur through December 31, 2019.

Please contact Alex Mankin, Geologist, at Globe Ranger District office of Tonto National Forest, at (928) 402-6200 or amankin@fs.fed.us, upon completion of the project or if you have any further questions.

Sincerely,

MICAH GRONDIN
District Ranger

RECEIVED
NOV 27 8:59
PHOENIX, ARIZONA



425399

May 21st, 2015

TO: BUREAU OF LAND MANAGEMENT
BUREAU OF LAND MANAGEMENT
ONE N. CENTRAL AVE
PHOENIX, ARIZONA 85004-2202

FROM: CHRISTOPHER KELLER
908 SO. 17TH AVE #14
PHOENIX, ARIZONA 85007

my LETTER IS TO CHANGE my
ADDRESS FROM:
911 SO. 17TH AVE
PHOENIX, ARIZONA 85007-3507

TO: 908 SO. 17TH AVE. ~~#14~~
#14
PHOENIX, ARIZONA 85007

my AMC IS 425399

THANK YOU,
Christopher J Keller



2015 MAY 26 P 4 21

CHRISTOPHER KELLER
908 SO. 17TH AVE #14
PHOENIX, ARIZONA 85007

PHOENIX AZ 850

22 MAY 2015 PM 8 L

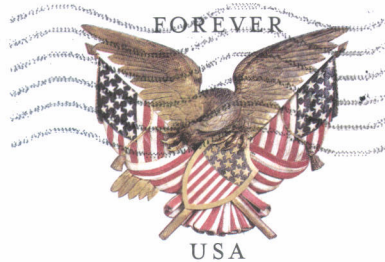

2015 MAY 26 P 4 27
PHOENIX, ARIZONA

USD OF INTERIOR
BUREAU OF LAND MANAGEMENT
ONE NORTH CENTRAL AVENUE
PHOENIX, ARIZONA 85004-2203

ATTN:
LAND/RECREATION
AND PLANNING

8500484427



© USPS 2013

THIS ENVELOPE IS RECYCLABLE AND MADE WITH 30% POST CONSUMER CONTENT



NOTICE!!

These documents have been scanned!

Do not place un-scanned documents beneath this notice!

Do not remove this notice from this file!

GPO Jacket No. 560-102
Print Order 61540
Rise Business Services, LLC
Job=AZ15 5/10/2019



Box Number= AZ15036



Claim Begin-End: AMC425399-AMC425399

3 Transfers



AZ15036-16

AMC425096-AMC425592

**NO
DOCUMENTS
FOUND**

NO DOCUMENTS FOUND
NO DOCUMENTS FOUND

NOTICE!!

These documents have been scanned!

Do not place un-scanned documents beneath this notice!

Do not remove this notice from this file!

GPO Jacket No. 560-102
Print Order 61540
Rise Business Services, LLC
Job=AZ15 5/10/2019



Box Number= AZ15036



Claim Begin-End: AMC425399-AMC425399

4 Miscellaneous



AZ15036-16

AMC425096-AMC425592

AZ	AMC430508	AMC430503	HAHN GREGORY A	8353 W ILIFF AVE	LAKEWOOD	CO	802273009	201504	PO BOX 2428			CORTARO	AZ	85652	2428
AZ	AMC430509	AMC430503	HAHN GREGORY A	8353 W ILIFF AVE	LAKEWOOD	CO	802273009	201504	PO BOX 2428			CORTARO	AZ	85652	2428
AZ	AMC430510	AMC430503	HAHN GREGORY A	8353 W ILIFF AVE	LAKEWOOD	CO	802273009	201504	PO BOX 2428			CORTARO	AZ	85652	2428
AZ	AMC430511	AMC430503	HAHN GREGORY A	8353 W ILIFF AVE	LAKEWOOD	CO	802273009	201504	PO BOX 2428			CORTARO	AZ	85652	2428
AZ	AMC430512	AMC430503	HAHN GREGORY A	8353 W ILIFF AVE	LAKEWOOD	CO	802273009	201504	PO BOX 2428			CORTARO	AZ	85652	2428
AZ	AMC430513	AMC430503	HAHN GREGORY A	8353 W ILIFF AVE	LAKEWOOD	CO	802273009	201504	PO BOX 2428			CORTARO	AZ	85652	2428
AZ	AMC430514	AMC430503	HAHN GREGORY A	8353 W ILIFF AVE	LAKEWOOD	CO	802273009	201504	PO BOX 2428			CORTARO	AZ	85652	2428
AZ	AMC430515	AMC430503	HAHN GREGORY A	8353 W ILIFF AVE	LAKEWOOD	CO	802273009	201504	PO BOX 2428			CORTARO	AZ	85652	2428
AZ	AMC430516	AMC430503	HAHN GREGORY A	8353 W ILIFF AVE	LAKEWOOD	CO	802273009	201504	PO BOX 2428			CORTARO	AZ	85652	2428
AZ	AMC430517	AMC430503	HAHN GREGORY A	8353 W ILIFF AVE	LAKEWOOD	CO	802273009	201504	PO BOX 2428			CORTARO	AZ	85652	2428
AZ	AMC430518	AMC430503	HAHN GREGORY A	8353 W ILIFF AVE	LAKEWOOD	CO	802273009	201504	PO BOX 2428			CORTARO	AZ	85652	2428
AZ	AMC424721	AMC424720	HARMON STEPHEN M	1080 W 3300 S APT 1083	SALT LAKE CITY	UT	841193372	201407	2846 S 9150 W			MAGNA	UT	84044	1048
AZ	AMC424720	AMC424720	HOBBS MARK RAY	PO BOX 47	WESTBY	MT	592750047	201406	2506 CEDAR AVE			GREELEY	CO	80631	7918
AZ	AMC424721	AMC424720	HOBBS MARK RAY	PO BOX 47	WESTBY	MT	592750047	201406	2506 CEDAR AVE			GREELEY	CO	80631	7918
AZ	AMC424723	AMC424720	HOBBS MARK RAY	PO BOX 47	WESTBY	MT	592750047	201406	2506 CEDAR AVE			GREELEY	CO	80631	7918
AZ	AMC428769	AMC428769	HOBBS MARK RAY	PO BOX 47	WESTBY	MT	592750047	201406	2506 CEDAR AVE			GREELEY	CO	80631	7918
AZ	AMC350435	AMC350435	HOFFMAN JOHN J	PO BOX 211	LAVEEN	AZ	853390211	201411	3504 W TANNER RANCH RD			QUEEN CREEK	AZ	85142	3044
AZ	AMC350436	AMC350435	HOFFMAN JOHN J	PO BOX 211	LAVEEN	AZ	853390211	201411	3504 W TANNER RANCH RD			QUEEN CREEK	AZ	85142	3044
AZ	AMC355908	AMC355908	HOFFMAN JOHN J	PO BOX 211	LAVEEN	AZ	853390211	201411	3504 W TANNER RANCH RD			QUEEN CREEK	AZ	85142	3044
AZ	AMC356376	AMC356376	HOFFMAN JOHN J	PO BOX 211	LAVEEN	AZ	853390211	201411	3504 W TANNER RANCH RD			QUEEN CREEK	AZ	85142	3044
AZ	AMC356377	AMC356376	HOFFMAN JOHN J	PO BOX 211	LAVEEN	AZ	853390211	201411	3504 W TANNER RANCH RD			QUEEN CREEK	AZ	85142	3044
AZ	AMC356378	AMC356376	HOFFMAN JOHN J	PO BOX 211	LAVEEN	AZ	853390211	201411	3504 W TANNER RANCH RD			QUEEN CREEK	AZ	85142	3044
AZ	AMC356379	AMC356376	HOFFMAN JOHN J	PO BOX 211	LAVEEN	AZ	853390211	201411	3504 W TANNER RANCH RD			QUEEN CREEK	AZ	85142	3044
AZ	AMC356616	AMC356616	HOFFMAN JOHN J	PO BOX 211	LAVEEN	AZ	853390211	201411	3504 W TANNER RANCH RD			QUEEN CREEK	AZ	85142	3044
AZ	AMC395803	AMC395803	HOFFMAN JOHN J	PO BOX 211	LAVEEN	AZ	853390211	201411	3504 W TANNER RANCH RD			QUEEN CREEK	AZ	85142	3044
AZ	AMC395804	AMC395803	HOFFMAN JOHN J	PO BOX 211	LAVEEN	AZ	853390211	201411	3504 W TANNER RANCH RD			QUEEN CREEK	AZ	85142	3044
AZ	AMC358799	AMC358798	JEWELL MAUREEN	1885 COUNTY ROAD	RIFLE	CO	816508421	201411	5122 MOOSEHOLLOW DR	UNIT 211		EDEN	UT	84310	6605
AZ	AMC364971	AMC364971	JEWELL MAUREEN	1885 COUNTY ROAD	RIFLE	CO	816508421	201411	5122 MOOSEHOLLOW DR	UNIT 211		EDEN	UT	84310	6605
AZ	AMC358799	AMC358798	JEWELL WILLIAM	1885 COUNTY ROAD	RIFLE	CO	816508421	201411	5122 MOOSEHOLLOW DR	UNIT 211		EDEN	UT	84310	6605
AZ	AMC364971	AMC364971	JEWELL WILLIAM	1885 COUNTY ROAD	RIFLE	CO	816508421	201411	5122 MOOSEHOLLOW DR	UNIT 211		EDEN	UT	84310	6605
AZ	AMC412555	AMC412553	JOHNSON CHRISTOPHER	6355 GENESEE ST	LANCASTER	NY	140869729	201412	1411 PERSIMMON WAY			LAKELAND	FL	33811	1518
AZ	AMC414503	AMC414489	JOHNSON MARC	2302 S DELAWARE ST	DENVER	CO	802234321	201412	3897 N BOUSE RD			GOLDEN VALLEY	AZ	86413	9379
AZ	AMC350130	AMC350128	JONES TIM	4143 N 27TH ST APT 11	PHOENIX	AZ	850165765	201408	8202 W PICCADILLY RD			PHOENIX	AZ	85033	3414
AZ	AMC425399	AMC425399	KELLER CHRISTOPHER	911 S 17TH AVE # 1	PHOENIX	AZ	850073507	201501	232 S 12TH AVE			PHOENIX	AZ	85007	3101
AZ	AMC397857	AMC397857	KRISHER JOSEPH	5326 CONGRESS AVE	MADISON	WI	537182273	201409	885 GARDEN DR	APT 122		SUN PRAIRIE	WI	53590	4172
AZ	AMC397858	AMC397857	KRISHER JOSEPH	5326 CONGRESS AVE	MADISON	WI	537182273	201409	885 GARDEN DR	APT 122		SUN PRAIRIE	WI	53590	4172
AZ	AMC397859	AMC397857	KRISHER JOSEPH	5326 CONGRESS AVE	MADISON	WI	537182273	201409	885 GARDEN DR	APT 122		SUN PRAIRIE	WI	53590	4172
AZ	AMC397860	AMC397857	KRISHER JOSEPH	5326 CONGRESS AVE	MADISON	WI	537182273	201409	885 GARDEN DR	APT 122		SUN PRAIRIE	WI	53590	4172
AZ	AMC417683	AMC417680	LATHROP DANIEL	1594 WADSWORTH	DIXON	IL	610218642	201503	PO BOX 762			AGUILA	AZ	85320	0762
AZ	AMC417683	AMC417680	LATHROP LISA	1594 WADSWORTH	DIXON	IL	610218642	201503	PO BOX 762			AGUILA	AZ	85320	0762
AZ	AMC430384	AMC430384	LATZY EDWARD J	PO BOX 4643	QUARTZSITE	AZ	853594643	201503	6475 BRANDYWINE DR			ANDOVER	OH	44003	9209
AZ	AMC404135	AMC404130	MILLAY HONEY	17210 E HILLCREST DR	FOUNTAIN HILLS	AZ	852686719	201411	15359 E LOTUS LN			FOUNTAIN HILLS	AZ	85268	4375
AZ	AMC404136	AMC404130	MILLAY HONEY	17210 E HILLCREST DR	FOUNTAIN HILLS	AZ	852686719	201411	15359 E LOTUS LN			FOUNTAIN HILLS	AZ	85268	4375
AZ	AMC413507	AMC413507	MOFFETT SHAWN	7350 W VEDA LN	KIRKLAND	AZ	863326074	201407	602 E MADISON AVE	UNIT 26		MILTON	WI	53563	1345
AZ	AMC417355	AMC417355	MOFFETT SHAWN	7350 W VEDA LN	KIRKLAND	AZ	863326074	201407	602 E MADISON AVE	UNIT 26		MILTON	WI	53563	1345
AZ	AMC421633	AMC421633	MOFFETT SHAWN	7350 W VEDA LN	KIRKLAND	AZ	863326074	201407	602 E MADISON AVE	UNIT 26		MILTON	WI	53563	1345
AZ	AMC310987	AMC310987	MONTGOMERY GEORGETTE	908 SELLERS DR NE	ALBUQUERQUE	NM	871125164	201407	1000 MADEIRA DR SE	APT 2		ALBUQUERQUE	NM	87108	4648
AZ	AMC310988	AMC310987	MONTGOMERY GEORGETTE	908 SELLERS DR NE	ALBUQUERQUE	NM	871125164	201407	1000 MADEIRA DR SE	APT 2		ALBUQUERQUE	NM	87108	4648
AZ	AMC310989	AMC310987	MONTGOMERY GEORGETTE	908 SELLERS DR NE	ALBUQUERQUE	NM	871125164	201407	1000 MADEIRA DR SE	APT 2		ALBUQUERQUE	NM	87108	4648

AZ	AMC310990	AMC310987	MONTGOMERY GEORGETTE	908 SELLERS DR NE	ALBUQUERQUE	NM	871125164	201407	1000 MADEIRA DR SE	APT 2	ALBUQUERQUE	NM	87108	4648
AZ	AMC310991	AMC310987	MONTGOMERY GEORGETTE	908 SELLERS DR NE	ALBUQUERQUE	NM	871125164	201407	1000 MADEIRA DR SE	APT 2	ALBUQUERQUE	NM	87108	4648
AZ	AMC310992	AMC310987	MONTGOMERY GEORGETTE	908 SELLERS DR NE	ALBUQUERQUE	NM	871125164	201407	1000 MADEIRA DR SE	APT 2	ALBUQUERQUE	NM	87108	4648
AZ	AMC311330	AMC311330	MONTGOMERY GEORGETTE	908 SELLERS DR NE	ALBUQUERQUE	NM	871125164	201407	1000 MADEIRA DR SE	APT 2	ALBUQUERQUE	NM	87108	4648
AZ	AMC311331	AMC311330	MONTGOMERY GEORGETTE	908 SELLERS DR NE	ALBUQUERQUE	NM	871125164	201407	1000 MADEIRA DR SE	APT 2	ALBUQUERQUE	NM	87108	4648
AZ	AMC311332	AMC311330	MONTGOMERY GEORGETTE	908 SELLERS DR NE	ALBUQUERQUE	NM	871125164	201407	1000 MADEIRA DR SE	APT 2	ALBUQUERQUE	NM	87108	4648
AZ	AMC371820	AMC371820	MONZON BENARDO	878 ENTRADA PL	CHULA VISTA	CA	919106527	201503	1338 NICOLETTE AVE	UNIT 1012	CHULA VISTA	CA	91913	3975
AZ	AMC371821	AMC371820	MONZON BENARDO	878 ENTRADA PL	CHULA VISTA	CA	919106527	201503	1338 NICOLETTE AVE	UNIT 1012	CHULA VISTA	CA	91913	3975
AZ	AMC412339	AMC412339	OLSON DAVID	26039 EDELWEISS CIR	EVERGREEN	CO	804395521	201503	9690 HARRISON ST		THORNTON	CO	80229	2825
AZ	AMC412340	AMC412339	OLSON DAVID	26039 EDELWEISS CIR	EVERGREEN	CO	804395521	201503	9690 HARRISON ST		THORNTON	CO	80229	2825
AZ	AMC412341	AMC412339	OLSON DAVID	26039 EDELWEISS CIR	EVERGREEN	CO	804395521	201503	9690 HARRISON ST		THORNTON	CO	80229	2825
AZ	AMC412342	AMC412339	OLSON DAVID	26039 EDELWEISS CIR	EVERGREEN	CO	804395521	201503	9690 HARRISON ST		THORNTON	CO	80229	2825
AZ	AMC413133	AMC413133	OLSON DAVID	26039 EDELWEISS CIR	EVERGREEN	CO	804395521	201503	9690 HARRISON ST		THORNTON	CO	80229	2825
AZ	AMC413134	AMC413133	OLSON DAVID	26039 EDELWEISS CIR	EVERGREEN	CO	804395521	201503	9690 HARRISON ST		THORNTON	CO	80229	2825
AZ	AMC413135	AMC413133	OLSON DAVID	26039 EDELWEISS CIR	EVERGREEN	CO	804395521	201503	9690 HARRISON ST		THORNTON	CO	80229	2825
AZ	AMC413136	AMC413133	OLSON DAVID	26039 EDELWEISS CIR	EVERGREEN	CO	804395521	201503	9690 HARRISON ST		THORNTON	CO	80229	2825
AZ	AMC427887	AMC427887	PEZZA DOMINICK	3450 N HUALAPAI WAY UNIT 2107	LAS VEGAS	NV	891298088	201411	6600 COASTAL BREEZE CT		LAS VEGAS	NV	89108	4353
AZ	AMC421119	AMC421119	POMICHTER RAYMOND M	9295 S STEVEN TRL	KIRKLAND	AZ	863325040	201503	10801 S STATE ROUTE		MAYER	AZ	86333	5804
AZ	AMC425532	AMC425532	PUCKETT JOE	6412 W ROMA AVE	PHOENIX	AZ	850332724	201405	PO BOX 778		DEWEY	AZ	86327	0778
AZ	AMC414354	AMC414338	RACHAL ADA MELODY	27523 N 17TH LN	PHOENIX	AZ	850855312	201403	16271 N 159TH AVE		SURPRISE	AZ	85374	5715
AZ	AMC414354	AMC414338	RACHAL KENNETH W SR	27523 N 17TH LN	PHOENIX	AZ	850855312	201403	16271 N 159TH AVE		SURPRISE	AZ	85374	5715
AZ	AMC399303	AMC399303	REDSTONE RESOURCES CORP	10920 W ALAMEDA AVE STE 207	LAKEWOOD	CO	802262680	201501	3948 MONTCLAIR LN		BOULDER	CO	80301	6019
AZ	AMC399304	AMC399303	REDSTONE RESOURCES CORP	10920 W ALAMEDA AVE STE 207	LAKEWOOD	CO	802262680	201501	3948 MONTCLAIR LN		BOULDER	CO	80301	6019
AZ	AMC402403	AMC402403	REDSTONE RESOURCES CORP	10920 W ALAMEDA AVE STE 207	LAKEWOOD	CO	802262680	201501	3948 MONTCLAIR LN		BOULDER	CO	80301	6019
AZ	AMC402404	AMC402403	REDSTONE RESOURCES CORP	10920 W ALAMEDA AVE STE 207	LAKEWOOD	CO	802262680	201501	3948 MONTCLAIR LN		BOULDER	CO	80301	6019
AZ	AMC402405	AMC402403	REDSTONE RESOURCES CORP	10920 W ALAMEDA AVE STE 207	LAKEWOOD	CO	802262680	201501	3948 MONTCLAIR LN		BOULDER	CO	80301	6019
AZ	AMC403038	AMC403038	REDSTONE RESOURCES CORP	10920 W ALAMEDA AVE STE 207	LAKEWOOD	CO	802262680	201501	3948 MONTCLAIR LN		BOULDER	CO	80301	6019
AZ	AMC403039	AMC403038	REDSTONE RESOURCES CORP	10920 W ALAMEDA AVE STE 207	LAKEWOOD	CO	802262680	201501	3948 MONTCLAIR LN		BOULDER	CO	80301	6019
AZ	AMC403040	AMC403038	REDSTONE RESOURCES CORP	10920 W ALAMEDA AVE STE 207	LAKEWOOD	CO	802262680	201501	3948 MONTCLAIR LN		BOULDER	CO	80301	6019
AZ	AMC403041	AMC403038	REDSTONE RESOURCES CORP	10920 W ALAMEDA AVE STE 207	LAKEWOOD	CO	802262680	201501	3948 MONTCLAIR LN		BOULDER	CO	80301	6019
AZ	AMC403042	AMC403038	REDSTONE RESOURCES CORP	10920 W ALAMEDA AVE STE 207	LAKEWOOD	CO	802262680	201501	3948 MONTCLAIR LN		BOULDER	CO	80301	6019
AZ	AMC403043	AMC403038	REDSTONE RESOURCES CORP	10920 W ALAMEDA AVE STE 207	LAKEWOOD	CO	802262680	201501	3948 MONTCLAIR LN		BOULDER	CO	80301	6019
AZ	AMC403044	AMC403038	REDSTONE RESOURCES CORP	10920 W ALAMEDA AVE STE 207	LAKEWOOD	CO	802262680	201501	3948 MONTCLAIR LN		BOULDER	CO	80301	6019
AZ	AMC403045	AMC403038	REDSTONE RESOURCES CORP	10920 W ALAMEDA AVE STE 207	LAKEWOOD	CO	802262680	201501	3948 MONTCLAIR LN		BOULDER	CO	80301	6019
AZ	AMC403046	AMC403038	REDSTONE RESOURCES CORP	10920 W ALAMEDA AVE STE 207	LAKEWOOD	CO	802262680	201501	3948 MONTCLAIR LN		BOULDER	CO	80301	6019
AZ	AMC403047	AMC403038	REDSTONE RESOURCES CORP	10920 W ALAMEDA AVE STE 207	LAKEWOOD	CO	802262680	201501	3948 MONTCLAIR LN		BOULDER	CO	80301	6019
AZ	AMC403048	AMC403038	REDSTONE RESOURCES CORP	10920 W ALAMEDA AVE STE 207	LAKEWOOD	CO	802262680	201501	3948 MONTCLAIR LN		BOULDER	CO	80301	6019
AZ	AMC403049	AMC403038	REDSTONE RESOURCES CORP	10920 W ALAMEDA AVE STE 207	LAKEWOOD	CO	802262680	201501	3948 MONTCLAIR LN		BOULDER	CO	80301	6019

AZ	AMC411003	AMC410998	REDSTONE RESOURCES CORP	10920 W ALAMEDA AVE STE 207	LAKEWOOD	CO	802262680	201501	3948 MONTCLAIR LN		BOULDER	CO	80301	6019
AZ	AMC395229	AMC395229	ROETKEN CLINT	10918 W MIAMI AVE	TOLLESON	AZ	853539462	201409	16644 E LAST TRAIL DR		FOUNTAIN HILLS	AZ	85268	6636
AZ	AMC395230	AMC395229	ROETKEN CLINT	10918 W MIAMI AVE	TOLLESON	AZ	853539462	201409	16644 E LAST TRAIL DR		FOUNTAIN HILLS	AZ	85268	6636
AZ	AMC395454	AMC395454	ROETKEN CLINT	10918 W MIAMI AVE	TOLLESON	AZ	853539462	201409	16644 E LAST TRAIL DR		FOUNTAIN HILLS	AZ	85268	6636
AZ	AMC412427	AMC412420	RUSSELL JORDAN	PO BOX 1264	KAMAS	UT	840361264	201502	1680 W 3000 S		HEBER CITY	UT	84032	3631
AZ	AMC420462	AMC420457	RUSSELL JORDAN	PO BOX 1264	KAMAS	UT	840361264	201502	1680 W 3000 S		HEBER CITY	UT	84032	3631
AZ	AMC389723	AMC389711	SABEL BRENT	11561 JAMAICA ST	HENDERSON	CO	806407688	201504	209 WINNIPEG ST		LOCHBUIE	CO	80603	9767
AZ	AMC412182	AMC412179	SABEL BRENT	11561 JAMAICA ST	HENDERSON	CO	806407688	201504	209 WINNIPEG ST		LOCHBUIE	CO	80603	9767
AZ	AMC413776	AMC413772	SANDOVAL ERIKA	5525 BALZAR AVE	LAS VEGAS	NV	891083101	201408	6312 MOLINO ST		LAS VEGAS	NV	89108	3909
AZ	AMC350141	AMC350128	SANSOM JAMES	50668 W VAL VISTA RD	MARICOPA	AZ	851395110	201407	10544 W KELSO DR		SUN CITY	AZ	85351	4856
AZ	AMC430232	AMC430232	SCHODER TIMOTHY	92-834 WAINOHIA ST	KAPOLEI	HI	967071222	201503	437 OAK ST		COLUSA	CA	95932	2631
AZ	AMC402225	AMC402225	SCHUSTER ROBERT	265 E LIBERTY LN	GILBERT	AZ	852964083	201411	1522 W CHILTON AVE		GILBERT	AZ	85233	4604
AZ	AMC429625	AMC429625	SHIEW JAMES A	PO BOX 1913	QUARTZSITE	AZ	853461913	201504	PO BOX 3134		BUENA VISTA	CO	81211	3134
AZ	AMC337791	AMC337791	SHORT STEVE	14641 N 90TH LN	PEORIA	AZ	853813542	201412	2225 N 83RD CIR		MESA	AZ	85207	2198
AZ	AMC399153	AMC399153	SHORT STEVE	14641 N 90TH LN	PEORIA	AZ	853813542	201412	2225 N 83RD CIR		MESA	AZ	85207	2198
AZ	AMC399154	AMC399153	SHORT STEVE	14641 N 90TH LN	PEORIA	AZ	853813542	201412	2225 N 83RD CIR		MESA	AZ	85207	2198
AZ	AMC396704	AMC396704	SORRELL JAMES	PO BOX 4566	FORT SMITH	AR	729144566	201411	4461 N BEAR CANYON		TUCSON	AZ	85749	9649
AZ	AMC396705	AMC396704	SORRELL JAMES	PO BOX 4566	FORT SMITH	AR	729144566	201411	4461 N BEAR CANYON		TUCSON	AZ	85749	9649
AZ	AMC396706	AMC396704	SORRELL JAMES	PO BOX 4566	FORT SMITH	AR	729144566	201411	4461 N BEAR CANYON		TUCSON	AZ	85749	9649
AZ	AMC396707	AMC396704	SORRELL JAMES	PO BOX 4566	FORT SMITH	AR	729144566	201411	4461 N BEAR CANYON		TUCSON	AZ	85749	9649
AZ	AMC396708	AMC396704	SORRELL JAMES	PO BOX 4566	FORT SMITH	AR	729144566	201411	4461 N BEAR CANYON		TUCSON	AZ	85749	9649
AZ	AMC396709	AMC396704	SORRELL JAMES	PO BOX 4566	FORT SMITH	AR	729144566	201411	4461 N BEAR CANYON		TUCSON	AZ	85749	9649
AZ	AMC396710	AMC396704	SORRELL JAMES	PO BOX 4566	FORT SMITH	AR	729144566	201411	4461 N BEAR CANYON		TUCSON	AZ	85749	9649
AZ	AMC383672	AMC383672	SORRELL JAMES D	PO BOX 4566	FORT SMITH	AR	729144566	201411	4461 N BEAR CANYON		TUCSON	AZ	85749	9649
AZ	AMC383673	AMC383672	SORRELL JAMES D	PO BOX 4566	FORT SMITH	AR	729144566	201411	4461 N BEAR CANYON		TUCSON	AZ	85749	9649
AZ	AMC383674	AMC383672	SORRELL JAMES D	PO BOX 4566	FORT SMITH	AR	729144566	201411	4461 N BEAR CANYON		TUCSON	AZ	85749	9649
AZ	AMC383675	AMC383672	SORRELL JAMES D	PO BOX 4566	FORT SMITH	AR	729144566	201411	4461 N BEAR CANYON		TUCSON	AZ	85749	9649
AZ	AMC383676	AMC383672	SORRELL JAMES D	PO BOX 4566	FORT SMITH	AR	729144566	201411	4461 N BEAR CANYON		TUCSON	AZ	85749	9649
AZ	AMC383677	AMC383672	SORRELL JAMES D	PO BOX 4566	FORT SMITH	AR	729144566	201411	4461 N BEAR CANYON		TUCSON	AZ	85749	9649
AZ	AMC383678	AMC383672	SORRELL JAMES D	PO BOX 4566	FORT SMITH	AR	729144566	201411	4461 N BEAR CANYON		TUCSON	AZ	85749	9649
AZ	AMC383679	AMC383672	SORRELL JAMES D	PO BOX 4566	FORT SMITH	AR	729144566	201411	4461 N BEAR CANYON		TUCSON	AZ	85749	9649
AZ	AMC383686	AMC383672	SORRELL JAMES D	PO BOX 4566	FORT SMITH	AR	729144566	201411	4461 N BEAR CANYON		TUCSON	AZ	85749	9649
AZ	AMC383687	AMC383672	SORRELL JAMES D	PO BOX 4566	FORT SMITH	AR	729144566	201411	4461 N BEAR CANYON		TUCSON	AZ	85749	9649
AZ	AMC383688	AMC383672	SORRELL JAMES D	PO BOX 4566	FORT SMITH	AR	729144566	201411	4461 N BEAR CANYON		TUCSON	AZ	85749	9649
AZ	AMC383689	AMC383672	SORRELL JAMES D	PO BOX 4566	FORT SMITH	AR	729144566	201411	4461 N BEAR CANYON		TUCSON	AZ	85749	9649
AZ	AMC383690	AMC383672	SORRELL JAMES D	PO BOX 4566	FORT SMITH	AR	729144566	201411	4461 N BEAR CANYON		TUCSON	AZ	85749	9649
AZ	AMC425532	AMC425532	STEPHENS JAYSON	10360 W ATLANTIS WAY	TOLLESON	AZ	853537644	201412	25119 N 51ST DR		PHOENIX	AZ	85083	4436
AZ	AMC355488	AMC355488	STIFF JOY	45 S 12TH ST	COTTAGE GROVE	OR	974242215	201501	3530 E GAME FARM RD	SPC 15	SPRINGFIELD	OR	97477	6004
AZ	AMC355488	AMC355488	STIFF KEITH	45 S 12TH ST	COTTAGE GROVE	OR	974242215	201501	3530 E GAME FARM RD	SPC 15	SPRINGFIELD	OR	97477	6004
AZ	AMC406412	AMC406412	TINNEY CHRISTOPHER M	6019 W MAUNA LOA LN	GLENDALE	AZ	853063839	201310	6324 W MERCER LN		GLENDALE	AZ	85304	3646
AZ	AMC424414	AMC424414	TOBEY STEVEN	4072 E WESTCHESTER	CHANDLER	AZ	852497303	201503	1695 E DANIELA DR		SAN TAN VALLEY	AZ	85140	4087
AZ	AMC414001	AMC414001	VAMPATELLA BIAGIO R	1560 N TORO DR	INVERNESS	FL	344531198	201410	3893 W GRANITE DR		MEADVIEW	AZ	86444	1843
AZ	AMC430519	AMC430519	VANATTI DUANE A	6433 OWEN DR	KALAMAZOO	MI	490098899	201411	PO BOX 1867		QUARTZSITE	AZ	85346	1867
AZ	AMC430520	AMC430519	VANATTI DUANE A	6433 OWEN DR	KALAMAZOO	MI	490098899	201411	PO BOX 1867		QUARTZSITE	AZ	85346	1867
AZ	AMC430521	AMC430519	VANATTI DUANE A	6433 OWEN DR	KALAMAZOO	MI	490098899	201411	PO BOX 1867		QUARTZSITE	AZ	85346	1867
AZ	AMC430522	AMC430519	VANATTI DUANE A	6433 OWEN DR	KALAMAZOO	MI	490098899	201411	PO BOX 1867		QUARTZSITE	AZ	85346	1867
AZ	AMC430523	AMC430519	VANATTI DUANE A	6433 OWEN DR	KALAMAZOO	MI	490098899	201411	PO BOX 1867		QUARTZSITE	AZ	85346	1867
AZ	AMC355446	AMC355446	VERDONE GINO M	10582 E WINDROSE DR	SCOTTSDALE	AZ	852592424	201501	9917 N 108TH ST		SCOTTSDALE	AZ	85259	4837
AZ	AMC355447	AMC355446	VERDONE GINO M	10582 E WINDROSE DR	SCOTTSDALE	AZ	852592424	201501	9917 N 108TH ST		SCOTTSDALE	AZ	85259	4837
AZ	AMC355448	AMC355446	VERDONE GINO M	10582 E WINDROSE DR	SCOTTSDALE	AZ	852592424	201501	9917 N 108TH ST		SCOTTSDALE	AZ	85259	4837
AZ	AMC420812	AMC420812	VIARS ART	14813 8TH AVE NE	SHORELINE	WA	981556949	201503	10301 214TH AVE E	TRLR 48	BONNEY LAKE	WA	98391	4208
AZ	AMC429007	AMC429007	WILLIAMS GWEN	200 BROKEN ARROW	SEDONA	AZ	863518743	201501	4620 E MINERAL RD		PHOENIX	AZ	85044	1125
AZ	AMC429008	AMC429007	WILLIAMS GWEN	200 BROKEN ARROW	SEDONA	AZ	863518743	201501	4620 E MINERAL RD		PHOENIX	AZ	85044	1125
AZ	AMC429009	AMC429007	WILLIAMS GWEN	200 BROKEN ARROW	SEDONA	AZ	863518743	201501	4620 E MINERAL RD		PHOENIX	AZ	85044	1125
AZ	AMC429010	AMC429007	WILLIAMS GWEN	200 BROKEN ARROW	SEDONA	AZ	863518743	201501	4620 E MINERAL RD		PHOENIX	AZ	85044	1125
AZ	AMC429011	AMC429007	WILLIAMS GWEN	200 BROKEN ARROW	SEDONA	AZ	863518743	201501	4620 E MINERAL RD		PHOENIX	AZ	85044	1125
AZ	AMC429012	AMC429007	WILLIAMS GWEN	200 BROKEN ARROW	SEDONA	AZ	863518743	201501	4620 E MINERAL RD		PHOENIX	AZ	85044	1125
AZ	AMC429013	AMC429007	WILLIAMS GWEN	200 BROKEN ARROW	SEDONA	AZ	863518743	201501	4620 E MINERAL RD		PHOENIX	AZ	85044	1125
AZ	AMC429014	AMC429007	WILLIAMS GWEN	200 BROKEN ARROW	SEDONA	AZ	863518743	201501	4620 E MINERAL RD		PHOENIX	AZ	85044	1125
AZ	AMC429015	AMC429007	WILLIAMS GWEN	200 BROKEN ARROW	SEDONA	AZ	863518743	201501	4620 E MINERAL RD		PHOENIX	AZ	85044	1125
AZ	AMC402382	AMC402382	WILLIS BOBBIE LOU	1112 S 1ST AVE	SAFFORD	AZ	855462128	201501	28 N TERRACE RD		CHANDLER	AZ	85226	4823

AZ	AMC402383	AMC402382	WILLIS BOBBIE LOU	1112 S 1ST AVE	SAFFORD	AZ	855462128	201501	28 N TERRACE RD		CHANDLER	AZ	85226	4823
AZ	AMC402384	AMC402382	WILLIS BOBBIE LOU	1112 S 1ST AVE	SAFFORD	AZ	855462128	201501	28 N TERRACE RD		CHANDLER	AZ	85226	4823
AZ	AMC402385	AMC402382	WILLIS BOBBIE LOU	1112 S 1ST AVE	SAFFORD	AZ	855462128	201501	28 N TERRACE RD		CHANDLER	AZ	85226	4823
AZ	AMC402386	AMC402382	WILLIS BOBBIE LOU	1112 S 1ST AVE	SAFFORD	AZ	855462128	201501	28 N TERRACE RD		CHANDLER	AZ	85226	4823
AZ	AMC402387	AMC402382	WILLIS BOBBIE LOU	1112 S 1ST AVE	SAFFORD	AZ	855462128	201501	28 N TERRACE RD		CHANDLER	AZ	85226	4823
AZ	AMC402388	AMC402382	WILLIS BOBBIE LOU	1112 S 1ST AVE	SAFFORD	AZ	855462128	201501	28 N TERRACE RD		CHANDLER	AZ	85226	4823
AZ	AMC402389	AMC402382	WILLIS BOBBIE LOU	1112 S 1ST AVE	SAFFORD	AZ	855462128	201501	28 N TERRACE RD		CHANDLER	AZ	85226	4823
AZ	AMC402390	AMC402382	WILLIS BOBBIE LOU	1112 S 1ST AVE	SAFFORD	AZ	855462128	201501	28 N TERRACE RD		CHANDLER	AZ	85226	4823
AZ	AMC332291	AMC332291	WINTER BRIAN	13610 CUNNING LN	LAKESIDE	CA	920404406	201411	14811 OLDE HIGHWAY 80		EL CAJON	CA	92021	2808
AZ	AMC417687	AMC417687	ZAPEL TODD OWEN	PO BOX 2598	QUARTZSITE	AZ	853462598	201311	PO BOX 37		QUARTZSITE	AZ	85346	0037

NOTICE!!

These documents have been scanned!

Do not place un-scanned documents beneath this notice!

Do not remove this notice from this file!

GPO Jacket No. 560-102
Print Order 61540
Rise Business Services, LLC
Job=AZ15 5/10/2019



Box Number= AZ15036



Claim Begin-End: AMC425399-AMC425399

5 Annual Filings



AZ15036-16

AMC425096-AMC425592

189

AMC

Form 3830-2
(January 2017)

UNITED STATES
DEPARTMENT OF THE INTERIOR
BUREAU OF LAND MANAGEMENT
MAINTENANCE FEE WAIVER CERTIFICATION

FORM APPROVED
OMB NO. 1004-0114
Expires: January 31, 2020

SEE INSTRUCTIONS ON PAGE 2

AMC 425399

1. This small miner waiver is filed for the assessment year beginning on September 1, 2018 and ending on September 1, 2019.
2. The undersigned and all related parties owned ten or fewer mining claims, mill, or tunnel sites located and maintained on Federal lands in the United States of America on September 1, 2018.
3. The undersigned have performed the assessment work required by law for each mining claim listed prior to filing this waiver and understand that by filing this form, the undersigned must file an affidavit of assessment work with the Bureau of Land Management (BLM) by the December 30th following the filing of this waiver.
4. The undersigned understand that if the assessment work obligation has not yet come due under 30 U.S.C. 28 (for those claims in their first assessment year only), a notice of intent to hold reciting this condition must be recorded by the December 30th following the filing of this waiver.
5. The undersigned understand that mill and tunnel sites may also be listed on this waiver and be waived from payment of the maintenance fee, and that a notice of intent to hold for these sites is required to be filed with the BLM by the December 30th following the filing of this waiver.
6. The undersigned understand and acknowledge that pursuant to 43 U.S.C. 1212 and 18 U.S.C. 1001, the filing or recording of a false, fictitious, or fraudulent document with the BLM may result in a fine of up to \$250,000, a prison term not to exceed five years, or both.
7. The mining claims, mill or tunnel sites for which this waiver from payment of the maintenance fees is requested are:

CLAIM OR SITE NAME	BLM RECORDATION SERIAL NUMBER
1. <u>Campwood</u>	<u>AMC 425399</u>
2.	
3.	
4.	
5.	
6.	
7.	
8.	
9.	
10.	

The owner(s) (claimants) of the above mining claims and sites are:

CHRISTOPHER JOHN KELLER
(Owner's Name - Please Print)
908 SO. 17th AVE #14 ✓
(Owner's Mailing Address)

Christopher John Keller
(Owner's Signature)
PHOENIX AZ 85007
(City) (State) (Zip Code)

(Owner's Name - Please Print)

(Owner's Signature)

(Owner's Mailing Address)

(City) (State) (Zip Code)

(Owner's Name - Please Print)

(Owner's Signature)

(Owner's Mailing Address)

(City) (State) (Zip Code)

(Owner's Name - Please Print)

(Owner's Signature)

(Owner's Mailing Address)

(City) (State) (Zip Code)

AC483
ENTERED SEP 05 2018
PB

RECEIVED
 BLM AZ STATE OFFICE
 2018 AUG 14 A 10:23
 PHOENIX, ARIZONA

(Continued on page 2)

MW/PS

(Owner's Name - Please Print)	(Owner's Signature)
(Owner's Mailing Address)	(City) (State) (Zip Code)
(Owner's Name - Please Print)	(Owner's Signature)
(Owner's Mailing Address)	(City) (State) (Zip Code)
(Owner's Name - Please Print)	(Owner's Signature)
(Owner's Mailing Address)	(City) (State) (Zip Code)
(Owner's Name - Please Print)	(Owner's Signature)
(Owner's Mailing Address)	(City) (State) (Zip Code)

18 U.S.C. 1001 and 43 U.S.C. 1212 make it a crime for any person knowingly and willfully to make to any department or agency of the United States any false, fictitious or fraudulent statements or representations as to any matter within its jurisdiction.

INSTRUCTIONS

1. This certification is made under the provisions of 43 U.S.C. § 1744 and 30 U.S.C. §28-28k and the regulations thereunder (43 CFR Part 3830).
2. The claimant(s) must fill in the dates in paragraph 1 for the beginning and ending of the assessment year for which this waiver is sought.
3. The claimant(s) must fill in the date in paragraph 2 for the beginning of the assessment year for which this waiver is sought.
4. All claim and site names and BLM serial numbers must be listed for the mining claims, mill sites, and tunnel sites for which the waiver is sought.
5. All owners of the mining claims, mill sites, and tunnel sites and their addresses must be given.
6. This waiver form must be signed by all the claimants or their designated agent, in original form. If an agent is designated, a notarized designation of agent, signed by all of the claimants with proper address given, must be submitted with this waiver.
7. This form must be filed no later than September 1st for the upcoming assessment year in the BLM State Office where the mining claims or sites are recorded, or the waiver cannot be granted by the BLM. (Example: To obtain a waiver for the assessment year 2012, which begins on September 1, 2011, you must qualify for and file for a waiver no later than September 1, 2011, in the proper BLM State Office.)
8. For all mining claims which require assessment work, you must record an affidavit of labor on or before the December 30th immediately following the filing of this waiver. For all other mining claims or sites waived, you must record a notice of intent to hold on or before the December 30th immediately following the filing of this waiver.
9. Mill and tunnel sites may also be listed on this waiver and be waived from payment of the maintenance fee. A notice of intent to hold for these sites is required to be filed by the December 30th following the filing of this waiver.

JUN 14 2018
 BLM STATE OFFICE
 PHOENIX, ARIZONA

PHOENIX, ARIZONA

2018 AUG 14 A 10:23

RECEIVED

BLM STATE OFFICE
FOR OFFICIAL USE ONLY

When Recorded Return Document to:

AMC 425399

Check here is this is a change of address.

Telephone: _____

E-mail address: _____

AFFIDAVIT OF PERFORMANCE OF ANNUAL WORK

1. State of Arizona, County of MARICOPA ss:

2. I (Name) CHRISTOPHER JOHN KELLER

3. Reside at (Address) 908 SO. 17TH AVE #14

City PHOENIX County MARICOPA

RECEIVED
BLM AZ STATE OFFICE
2018 AUG 14 A 10:23
PHOENIX, ARIZONA
BLM
Date
Stamp

State AZ Zip 85007 being duly sworn, depose and say that I am a citizen of the United States, more than eighteen years of age, and that all of the facts set forth in this affidavit, subject to the provisions and penalties of 18 U.S.C. 1001 pertaining to the filing of false, fictitious, or fraudulent statements with the United States, are true and correct according to the best of my knowledge, information and belief.

4. Owner's name and address (If not shown in Items 1-3 above). _____

5. That I am personally acquainted with the mining claim(s). The work and improvements were made by and at the expense of the owner(s) of said claim(s). Said contiguous group of claims, listed on this document, are situated in the

_____ (optional) Mining District; _____ County, Arizona.

Line No.	AMC NUMBER	CLAIM/SITE NAME	COUNTY RECORDER DATA (If available)	TWP	RNG	SEC
1	425399	CAMPWOOD		6N	5E	25
2						
3						
4						
5						
6						

ENTERED
AUG 23 2018
BY: [Signature]

Form: MCF108
Revised July 2014
Page 1 of 2

Dec. 30, 2018

RECEIVED
BLM AZ STATE OFFICE
2018 AUG 14 A 10:23
PHOENIX, ARIZONA

7						
8						
9						
10						

6. That between the dates starting at 12 o'clock noon on September 1, 20 17 and ending at 12 o'clock noon on September 1, 20 18 at least \$ 100 dollars worth of work and improvements were done and performed upon said claim(s) or upon one or more of a contiguous group of claims for the benefit of all, wholly or partly outside of a contiguous group of claims for the benefit of all, not including the location work.

7. That the following persons were employed to perform the work and improvements described herein: CHRISTOPHER JOHN KELLER, "CLAIMANT"

8. That the work and improvements performed were: EXCAVATED FAULTS # 1-5 to end of location on claim, screening, magnet, and detector. CHEMICAL survey to determine ability cleaning ore (hydrochloric acid) excavated at best mineral spots, covered metal 01300 IF WEST END.

9. Dated: 8/14/18 Signature: Christopher John Keller

SUBSCRIBED AND SWORN TO before me, a Notary Public, this 14th day of August 20 18.

By: Karla Rosales

Notary Public [Signature]

My Commission Expires January 12, 2021



Bureau of Land Management
Arizona State Office
www.blm.gov/az

No. of Claims: 1 x \$10 = 10
 Check No.: CC Init. JMR
 Receipt No.: 4234792
 For BLM Use Only

United States Department of the Interior
Bureau of Land Management
 DIV OF LANDS, MINRLS & ENERGY
 ONE N CENTRAL AVE
 PHOENIX, AZ 85004 -4427
 Phone: 602-417-9200

Receipt

No: 4234792

Transaction #: 4350148	
Date of Transaction: 08/14/2018	
CUSTOMER:	
CHRISTOPHER KELLER 908 S 17TH AVE # 14 PHOENIX, AZ 85007-3508 US	

LINE #	QTY	DESCRIPTION	REMARKS	UNIT PRICE	TOTAL
1	1.00	LOCATABLE MINERALS / MINING CLAIMS- NOT NEW-UNADJUD, ONE AUTH NO. ONLY / MINING CLAIM MONEY RECEIVED CASES: AMC425399/\$10.00	POL 2018/1 WAV	- n/a -	10.00
TOTAL:					\$10.00

PAYMENT INFORMATION					
NOTE: Items will appear on credit card statement as "Bureau of Land Mgmt CO".					
1	AMOUNT:	10.00	POSTMARKED:	N/A	
	TYPE:	CREDIT CARD	RECEIVED:	08/14/2018	
	NAME:	KELLER, CHRISTOPHER 908 S 17TH AVE # 14 PHOENIX AZ 85007-3508 US			
	CARD NO:	XXXXXXXXXXXX7892	AUTH CODE:	003113	
	NAME ON CARD:	CHRISTOPHER J KELLER			
	SIGNATURE:				

REMARKS

This receipt was generated by the automated BLM Collections and Billing System and is a paper representation of a portion of the official electronic record contained therein.

When Recorded Return Document to:

425399

Check here is this is a change of address.

Telephone: 480-740-7832

E-mail address: _____

AFFIDAVIT OF PERFORMANCE OF ANNUAL WORK

1. State of Arizona, County of MARICOPA ss:

2. I (Name) CHRISTOPHER JOHN KELLER

3. Reside at (Address) 908 SOUTH 17TH AVE
#14

City PHOENIX County MARICOPA

State AZ Zip 85007 being duly sworn, depose and say that I am a citizen of the United States, more than eighteen years of age, and that all of the facts set forth in this affidavit, subject to the provisions and penalties of 18 U.S.C. 1001 pertaining to the filing of false, fictitious, or fraudulent statements with the United States, are true and correct according to the best of my knowledge, information and belief.

4. Owner's name and address (If not shown in Items 1-3 above). _____

5. That I am personally acquainted with the mining claim(s). The work and improvements were made by and at the expense of the owner(s) of said claim(s). Said contiguous group of claims, listed on this document, are situated in the

_____ (optional) Mining District; _____ County, Arizona.

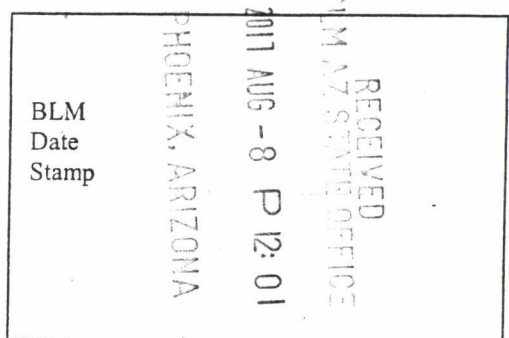

Line No.	AMC NUMBER	CLAIM/SITE NAME	COUNTY RECORDER DATA (If available)	TWP	RNG	SEC
1	425-399	CAMPWOOD		6N	5E	25
2						
3						
4						
5						
6						

Form: MCF108
Revised July 2014
Page 1 of 2



RECEIVED
 BLM AZ STATE OFFICE
 PHOENIX, ARIZONA
 2017 AUG - 8 P 12: 01
 BLM
 Date
 Stamp

7						
8						
9						
10						

6. That between the dates starting at 12 o'clock noon on September 1, 20 16 and ending at 12 o'clock noon on September 1, 20 17 at least \$ 100 dollars worth of work and improvements were done and performed upon said claim(s) or upon one or more of a contiguous group of claims for the benefit of all, wholly or partly outside of a contiguous group of claims for the benefit of all, not including the location work.

7. That the following persons were employed to perform the work and improvements described herein: _____

8. That the work and improvements performed were: EXCAVATED UNREFINED IRON PIECES AND UNREFINED

SOLD PIECES including new discoveries on the entire placer location, 20 acre mining claim, as well as separating iron ore and gold dust, both dust form. INCLUDED this year was a north to south staking ^{EAST TO WEST} _{STAKE}

9. Dated: 8/8/17 Signature: Christopher John Keller

SUBSCRIBED AND SWORN TO before me, a Notary Public, this 8th day of August 20 17

By: Christopher John Keller

Notary Public [Signature]

My Commission Expires 3/27/2020

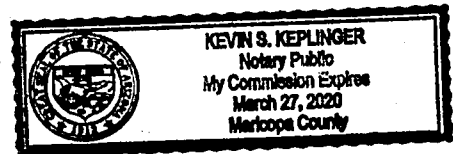

Bureau of Land Management
 Arizona State Office
www.blm.gov/az

No. of Claims: 1 x \$10 = 10.00
 Check No.: CC Init. [Signature]
 Receipt No.: 3926870
 For BLM Use Only

United States Department of the Interior
Bureau of Land Management
 DIV OF LANDS, MINRLS & ENERGY
 ONE N CENTRAL AVE
 PHOENIX, AZ 85004 -4427
 Phone: 602-417-9200

Receipt

No: 3926870

Transaction #: 4036408	
Date of Transaction: 08/08/2017	
CUSTOMER:	
CHRISTOPHER KELLER 908 S 17TH AVE PHOENIX, AZ 85007-3508 US	

LINE #	QTY	DESCRIPTION	REMARKS	UNIT PRICE	TOTAL
1	1.00	LOCATABLE MINERALS / MINING CLAIMS- NOT NEW-UNADJUD, ONE AUTH NO. ONLY / MINING CLAIM MONEY RECEIVED CASES: AMC425399/\$10.00	2017 POL & 2018 WAIV (1)	- n/a -	10.00
TOTAL:					\$10.00

PAYMENT INFORMATION			
NOTE: Items will appear on credit card statement as "Bureau of Land Mgmt CO".			
1	AMOUNT:	10.00	POSTMARKED: N/A
	TYPE:	CREDIT CARD	RECEIVED: 08/08/2017
	NAME:	KELLER, CHRISTOPHER 908 S 17TH AVE PHOENIX AZ 85007-3508 US	
	CARD NO:	XXXXXXXXXXXX7492	AUTH CODE: 06664A
	NAME ON CARD:	CHRIS J KELLER	
	EXPIRES:	12/2018	
	SIGNATURE:		

REMARKS

This receipt was generated by the automated BLM Collections and Billing System and is a paper representation of a portion of the official electronic record contained therein.

425399

Form 3830-2
(January 2017)

UNITED STATES
DEPARTMENT OF THE INTERIOR
BUREAU OF LAND MANAGEMENT
MAINTENANCE FEE WAIVER CERTIFICATION

137

FORM APPROVED
OMB NO. 1004-0114
Expires: January 31, 2020

SEE INSTRUCTIONS ON PAGE 2

1. This small miner waiver is filed for the assessment year beginning on September 1, 2017 and ending on September 1, 2018.
2. The undersigned and all related parties owned ten or fewer mining claims, mill, or tunnel sites located and maintained on Federal lands in the United States of America on September 1, 2017.
3. The undersigned have performed the assessment work required by law for each mining claim listed prior to filing this waiver and understand that by filing this form, the undersigned must file an affidavit of assessment work with the Bureau of Land Management (BLM) by the December 30th following the filing of this waiver.
4. The undersigned understand that if the assessment work obligation has not yet come due under 30 U.S.C. 28 (for those claims in their first assessment year only), a notice of intent to hold reciting this condition must be recorded by the December 30th following the filing of this waiver.
5. The undersigned understand that mill and tunnel sites may also be listed on this waiver and be waived from payment of the maintenance fee, and that a notice of intent to hold for these sites is required to be filed with the BLM by the December 30th following the filing of this waiver.
6. The undersigned understand and acknowledge that pursuant to 43 U.S.C. 1212 and 18 U.S.C. 1001, the filing or recording of a false, fictitious, or fraudulent document with the BLM may result in a fine of up to \$250,000, a prison term not to exceed five years, or both.
7. The mining claims, mill or tunnel sites for which this waiver from payment of the maintenance fees is requested are:

CLAIM OR SITE NAME	BLM RECORDATION SERIAL NUMBER
1. <u>CAMPWOOD</u>	<u>Amc 425-399</u>
2.	
3.	
4.	
5.	
6.	
7.	
8.	
9.	
10.	

The owner(s) (claimants) of the above mining claims and sites are:

CHRISTOPHER JOHN KELLER
(Owner's Name - Please Print)
908 SOUTH 17th AVE #14
(Owner's Mailing Address)

Christopher John Keller
(Owner's Signature)
PHOENIX AZ 85007
(City) (State) (Zip Code)

(Owner's Name - Please Print)

(Owner's Mailing Address)

(Owner's Signature)

(City) (State) (Zip Code)

(Owner's Name - Please Print)

(Owner's Mailing Address)

(Owner's Signature)

(City) (State) (Zip Code)

4253
ENTERED
AUG 31 2017
(Owner's Name - Please Print)
PHOENIX, ARIZONA
(Owner's Mailing Address)

2017 AUG - 8 - 11:35
RECEIVED
BLM AZ STATE OFFICE
(Owner's Signature)

(City) (State) (Zip Code)

(Continued on page 2)

aw

(Owner's Name - Please Print)	(Owner's Signature)		
(Owner's Mailing Address)	(City)	(State)	(Zip Code)
(Owner's Name - Please Print)	(Owner's Signature)		
(Owner's Mailing Address)	(City)	(State)	(Zip Code)
(Owner's Name - Please Print)	(Owner's Signature)		
(Owner's Mailing Address)	(City)	(State)	(Zip Code)
(Owner's Name - Please Print)	(Owner's Signature)		
(Owner's Mailing Address)	(City)	(State)	(Zip Code)

18 U.S.C. 1001 and 43 U.S.C. 1212 make it a crime for any person knowingly and willfully to make to any department or agency of the United States any false, fictitious or fraudulent statements or representations as to any matter within its jurisdiction.

INSTRUCTIONS

1. This certification is made under the provisions of 43 U.S.C. § 1744 and 30 U.S.C. §28-28k and the regulations thereunder (43 CFR Part 3830).
2. The claimant(s) must fill in the dates in paragraph 1 for the beginning and ending of the assessment year for which this waiver is sought.
3. The claimant(s) must fill in the date in paragraph 2 for the beginning of the assessment year for which this waiver is sought.
4. All claim and site names and BLM serial numbers must be listed for the mining claims, mill sites, and tunnel sites for which the waiver is sought.
5. All owners of the mining claims, mill sites, and tunnel sites and their addresses must be given.
6. This waiver form must be signed by all the claimants or their designated agent, in original form. If an agent is designated, a notarized designation of agent, signed by all of the claimants with proper address given, must be submitted with this waiver.
7. This form must be filed no later than September 1st for the upcoming assessment year in the BLM State Office where the mining claims or sites are recorded, or the waiver cannot be granted by the BLM. (Example: To obtain a waiver for the assessment year 2012, which begins on September 1, 2011, you must qualify for and file for a waiver no later than September 1, 2011, in the proper BLM State Office.)
8. For all mining claims which require assessment work, you must record an affidavit of labor on or before the December 30th immediately following the filing of this waiver. For all other mining claims or sites waived, you must record a notice of intent to hold on or before the December 30th immediately following the filing of this waiver.
9. Mill and tunnel sites may also be listed on this waiver and be waived from payment of the maintenance fee. A notice of intent to hold for these sites is required to be filed by the December 30th following the filing of this waiver.

FOR OFFICIAL USE ONLY

PHOENIX, ARIZONA

2011 AUG - 8 A 11: 35

RECEIVED
BLM AZ STATE OFFICE

UNITED STATES
DEPARTMENT OF THE INTERIOR
BUREAU OF LAND MANAGEMENT

36

4me

425399

MAINTENANCE FEE WAIVER CERTIFICATION

FORM APPROVED
OMB NO. 1004-0114
Expires: October 31, 2016

SEE INSTRUCTIONS ON PAGE 2

- This small miner waiver is filed for the assessment year beginning on September 1, 2016 and ending on September 1, 2017.
- The undersigned and all related parties owned ten or fewer mining claims, mill, or tunnel sites located and maintained on Federal lands in the United States of America on September 1, 2016.
- The undersigned have performed the assessment work required by law for each mining claim listed prior to filing this waiver and understand that by filing this form, the undersigned must file an affidavit of assessment work with the Bureau of Land Management (BLM) by the December 30th following the filing of this waiver.
- The undersigned understand that if the assessment work obligation has not yet come due under 30 U.S.C. 28 (for those claims in their first assessment year only), a notice of intent to hold reciting this condition must be recorded by the December 30th following the filing of this waiver.
- The undersigned understand that mill and tunnel sites may also be listed on this waiver and be waived from payment of the maintenance fee, and that a notice of intent to hold for these sites is required to be filed with the BLM by the December 30th following the filing of this waiver.
- The undersigned understand and acknowledge that pursuant to 43 U.S.C. 1212 and 18 U.S.C. 1001, the filing or recording of a false, fictitious, or fraudulent document with the BLM may result in a fine of up to \$250,000, a prison term not to exceed five years, or both.
- The mining claims, mill or tunnel sites for which this waiver from payment of the maintenance fees is requested are:

CLAIM OR SITE NAME	BLM RECORDATION SERIAL NUMBER
1. CAMPWOOD	Ame 425-399
2.	
3.	
4.	
5.	
6.	
7.	
8.	
9.	
10.	

The owner(s) (claimants) of the above mining claims and sites are:

CHRISTOPHER JOHN KELLER
 (Owner's Name - Please Print)
 908 SOUTH 17TH AVE #14
 (Owner's Mailing Address)

Christopher John Keller
 (Owner's Signature)
 PHOENIX AZ 85007
 (City) (State) (Zip Code)

(Owner's Name - Please Print)

(Owner's Signature)

(Owner's Mailing Address)

(City)

(State)

(Zip Code)

(Owner's Name - Please Print)

(Owner's Signature)

(Owner's Mailing Address)

(City)

(State)

(Zip Code)

(Owner's Name - Please Print)

(Owner's Signature)

(Owner's Mailing Address)

(City)

(State)

(Zip Code)

(Continued on page 2)

ENTERED
 493
 AUG 29 2016

BY: km

2016 MAY 19 12:56 PM
 RECEIVED
 BLM ARIZONA STATE OFFICE
 PHOENIX, ARIZONA

NW
RM

FILE # 52

RECEIVED
AZ STATE OFFICE

2016 MAY 19 P 12:56

PHOENIX, ARIZONA



When Recorded Return Document

425399

Check here is this is a change of address.

Telephone: 480-740-7832

E-mail address: _____

AFFIDAVIT OF PERFORMANCE OF ANNUAL WORK

1. State of Arizona, County of MARICOPA ss:

2. I (Name) CHRISTOPHER JOHN KELLER

3. Reside at (Address) 908 SOUTH 17TH AVE #14

City PHOENIX County MARICOPA

State AZ Zip 85007 being duly sworn, depose and say that I am a citizen of the United States, more than eighteen years of age, and that all of the facts set forth in this affidavit, subject to the provisions and penalties of 18 U.S.C. 1001 pertaining to the filing of false, fictitious, or fraudulent statements with the United States, are true and correct according to the best of my knowledge, information and belief.

4. Owner's name and address (If not shown in Items 1-3 above). _____

5. That I am personally acquainted with the mining claim(s). The work and improvements were made by and at the expense of the owner(s) of said claim(s). Said contiguous group of claims, listed on this document, are situated in the

_____ (optional) Mining District; _____ County, Arizona.

Line No.	AMC NUMBER	CLAIM/SITE NAME	COUNTY RECORDER DATA (if available)	TWP	RNG	SEC
1	425399	CAMPWOOD		6N	5E	25
2						
3						
4						
5						
6						

RECEIVED
 ARIZONA STATE OFFICE
 MAY 19 12:56
 PHOENIX, ARIZONA
 BLM
 Date
 Stamp

Form: MCF108
Revised July 2014
Page 1 of 2

ENTERED
MAY 20 2016
BY: Ram

RECEIVED
BLM AZ STATE OFFICE
2016 MAY 19 P 12:50
PHOENIX, ARIZONA

BLM
Date
Stamp

7						
8						
9						
10						

6. That between the dates starting at 12 o'clock noon on September 1, 20 15 and ending at 12 o'clock noon on September 1, 20 16 at least \$ 100.00 dollars worth of work and improvements were done and performed upon said claim(s) or upon one or more of a contiguous group of claims for the benefit of all, wholly or partly outside of a contiguous group of claims for the benefit of all, not including the location work.

7. That the following persons were employed to perform the work and improvements described herein: _____

8. That the work and improvements performed were: PICKING AND EXCAVATION OF A MINING CLAIM. SHOVELING AND EXCAVATION OF A MINING CLAIM. EXCAVATION OF A MINING CLAIM.

9. Dated: 5/19/16 Signature: Christopher John Keller

SUBSCRIBED AND SWORN TO before me, a Notary Public, this 19th day of May 20 16

By: Christopher John Keller

Notary Public [Signature]

My Commission Expires 1/24/2018

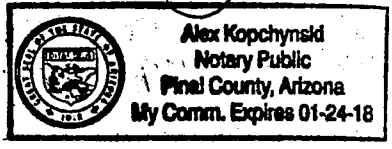

Bureau of Land Management
Arizona State Office
www.blm.gov/az

No. of Claims: 1 x \$10 = 10
 Check No.: Cash init. JMK
 Receipt No.: 3564014
 For BLM Use Only

612 115 YAM



File Code: 2810

Date: March 25, 2015

AMC 425399

Christopher Keller
232 S. 12th Avenue
Phoenix, AZ 85007

Dear Mr. Keller,

We have reviewed your Notice of Intent to conduct prospecting operations on your Campwood placer claim located in Section 25 of Township 6 North, Range 5 East, Gila and Salt River Base Line and Meridian, Arizona.

Significant surface disturbance is not anticipated resulting from your proposed activity; therefore, no reclamation performance bond will be required. The activities are accepted as submitted with the following conditions mutually understood:

1. No more than one person will be working the claim at any one time.
2. Vehicular access to the area will be from Forest Road (FR) 19, Bartlett Lake Road, to Camp Creek. From Camp Creek, access to your claim will be by foot.
3. Tools are restricted to a hand shovel, a screen, a 5-gallon bucket, and a magnet; no mechanized tools or structures are permitted.
4. Vegetation will be avoided by all prospecting activities.
5. The maximum amount of material to be processed from within your claim will be less than 5 cubic yards, or 200 five-gallon buckets.
6. The number of five-gallon buckets filled and removed per visit to your claim will be annotated on a log, developed by you, and submitted to the Cave Creek Ranger District upon completion of your prospecting activities. This log will also note the date of each visit.
7. Waste generated by project activities will be removed from National Forest System lands daily, and disposed of in accordance with applicable laws and regulations.
8. All Tonto National Forest fire restrictions and closures will be complied with.
9. Acknowledgement of this activity will remain in effect until March 25, 2016.

Please contact Jason Scow at the Cave Creek/Mesa Ranger District (480) 610- 3330 if you have questions.

Sincerely,

LOUISE CONGDON
District Ranger

PHOENIX, ARIZONA
2016 MAY 19 P 12: 56
RECEIVED
BLM AZ STATE OFFICE



RECEIVED
BLM AZ STATE OFFICE

2016 MAY 19 P 12: 56

PHOENIX, ARIZONA

United States Department of the Interior
Bureau of Land Management
 DIV OF LANDS, MINRLS & ENERGY
 ONE N CENTRAL AVE
 PHOENIX, AZ 85004 -4427
 Phone: 602-417-9200

Receipt

No: 3564014

Transaction #: 3666791	
Date of Transaction: 05/19/2016	
CUSTOMER:	
CHRISTOPHER KELLER 908 S 17TH AVE PHOENIX,AZ 85007-3508 US	

LINE #	QTY	DESCRIPTION	REMARKS	UNIT PRICE	TOTAL
1	1.00	LOCATABLE MINERALS / MINING CLAIMS- NOT NEW-UNADJUD,ONE AUTH NO. ONLY / MINING CLAIM MONEY RECEIVED CASES: AMC425399/\$10.00	POL 2016/1 WAV	- n/a -	10.00
TOTAL:					\$10.00

PAYMENT INFORMATION			
1	AMOUNT:	10.00	POSTMARKED: N/A
	TYPE:	CASH	RECEIVED: 05/19/2016
	NAME:	KELLER, CHRISTOPHER 908 S 17TH AVE PHOENIX AZ 85007-3508 US	

REMARKS

This receipt was generated by the automated BLM Collections and Billing System and is a paper representation of a portion of the official electronic record contained therein.

425 399

46

me

Form 3830-2
(October 2013)

UNITED STATES
DEPARTMENT OF THE INTERIOR
BUREAU OF LAND MANAGEMENT

MAINTENANCE FEE WAIVER CERTIFICATION

FORM APPROVED
OMB NO. 1004-0114
Expires: October 31, 2016

SEE INSTRUCTIONS ON PAGE 2

1. This small miner waiver is filed for the assessment year beginning on September 1, 2015 and ending on September 1, 2016.
2. The undersigned and all related parties owned ten or fewer mining claims, mill, or tunnel sites located and maintained on Federal lands in the United States of America on September 1, 2015.
3. The undersigned have performed the assessment work required by law for each mining claim listed prior to filing this waiver and understand that by filing this form, the undersigned must file an affidavit of assessment work with the Bureau of Land Management (BLM) by the December 30th following the filing of this waiver.
4. The undersigned understand that if the assessment work obligation has not yet come due under 30 U.S.C. 28 (for those claims in their first assessment year only), a notice of intent to hold reciting this condition must be recorded by the December 30th following the filing of this waiver.
5. The undersigned understand that mill and tunnel sites may also be listed on this waiver and be waived from payment of the maintenance fee, and that a notice of intent to hold for these sites is required to be filed with the BLM by the December 30th following the filing of this waiver.
6. The undersigned understand and acknowledge that pursuant to 43 U.S.C. 1212 and 18 U.S.C. 1001, the filing or recording of a false, fictitious, or fraudulent document with the BLM may result in a fine of up to \$250,000, a prison term not to exceed five years, or both.
7. The mining claims, mill or tunnel sites for which this waiver from payment of the maintenance fees is requested are:

CLAIM OR SITE NAME	BLM RECORDATION SERIAL NUMBER
1. <u>CAMPWOOD</u> ✓	<u>AMC 425-399</u>
2.	
3.	
4.	
5.	
6.	
7.	
8.	
9.	
10.	

The owner(s) (claimants) of the above mining claims and sites are:

CHRISTOPHER JOHN KELLER
(Owner's Name - Please Print)
908 SOUTH 17TH AVE #14
(Owner's Mailing Address)

Christopher John Keller
(Owner's Signature)
PHOENIX AZ 85007
(City) (State) (Zip Code)

(Owner's Name - Please Print)

(Owner's Mailing Address)

(Owner's Signature)

(City) (State) (Zip Code)

(Owner's Name - Please Print)

(Owner's Mailing Address)

(Owner's Signature)

(City) (State) (Zip Code)

(Owner's Name - Please Print)

(Owner's Mailing Address)

(Owner's Signature)

(City) (State) (Zip Code)

INTEREST
SEP 01 2015
BY: *me*

RECEIVED
BLM ARIZONA STATE OFFICE
2015 JUN 12 P 1:22
PHOENIX, ARIZONA

(Continued on page 2)

NWV
9/1/2015
me

(Owner's Name - Please Print)	(Owner's Signature)
(Owner's Mailing Address)	(City) (State) (Zip Code)
(Owner's Name - Please Print)	(Owner's Signature)
(Owner's Mailing Address)	(City) (State) (Zip Code)
(Owner's Name - Please Print)	(Owner's Signature)
(Owner's Mailing Address)	(City) (State) (Zip Code)
(Owner's Name - Please Print)	(Owner's Signature)
(Owner's Mailing Address)	(City) (State) (Zip Code)

18 U.S.C. 1001 and 43 U.S.C. 1212 make it a crime for any person knowingly and willfully to make to any department or agency of the United States any false, fictitious or fraudulent statements or representations as to any matter within its jurisdiction.

INSTRUCTIONS

1. This certification is made under the provisions of 43 U.S.C. § 1744 and 30 U.S.C. §28-28k and the regulations thereunder (43 CFR Part 3830).
2. The claimant(s) must fill in the dates in paragraph 1 for the beginning and ending of the assessment year for which this waiver is sought.
3. The claimant(s) must fill in the date in paragraph 2 for the beginning of the assessment year for which this waiver is sought.
4. All claim and site names and BLM serial numbers must be listed for the mining claims, mill sites, and tunnel sites for which the waiver is sought.
5. All owners of the mining claims, mill sites, and tunnel sites and their addresses must be given.
6. This waiver form must be signed by all the claimants or their designated agent, in original form. If an agent is designated, a notarized designation of agent, signed by all of the claimants with proper address given, must be submitted with this waiver.
7. This form must be filed no later than September 1st for the upcoming assessment year in the BLM State Office where the mining claims or sites are recorded, or the waiver cannot be granted by the BLM. (Example: To obtain a waiver for the assessment year 2012, which begins on September 1, 2011, you must qualify for and file for a waiver no later than September 1, 2011, in the proper BLM State Office.)
8. For all mining claims which require assessment work, you must record an affidavit of labor on or before the December 30th immediately following the filing of this waiver. For all other mining claims or sites waived, you must record a notice of intent to hold on or before the December 30th immediately following the filing of this waiver.
9. Mill and tunnel sites may also be listed on this waiver and be waived from payment of the maintenance fee. A notice of intent to hold for these sites is required to be filed by the December 30th following the filing of this waiver.

PHOENIX, ARIZONA
 2015 JUN 12 P 1:22
 RECEIVED
 BLM AZ STATE OFFICE

FOR OFFICIAL USE ONLY

When Recorded Return Document No:

425399

Check here if this is a change of address.

Telephone: 480-740-7832

E-mail address: _____

ADDRESS UPDATED
6/17/15 RAM

AFFIDAVIT OF PERFORMANCE OF ANNUAL WORK

1. State of Arizona, County of MARICOPA ss:

2. I (Name) CHRISTOPHER JOHN KELLER

3. Reside at (Address) 908 SOUTH 17th AVE #14

City PHOENIX County MARICOPA

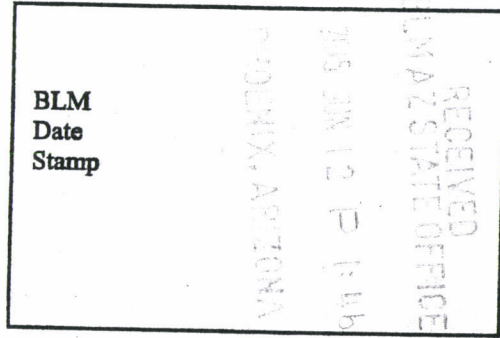

State AZ, Zip 85007 being duly sworn, depose and say that I am a citizen of the United States, more than eighteen years of age, and that all of the facts set forth in this affidavit, subject to the provisions and penalties of 18 U.S.C. 1001 pertaining to the filing of false, fictitious, or fraudulent statements with the United States, are true and correct according to the best of my knowledge, information and belief.

4. Owner's name and address (If not shown in Items 1-3 above), _____

5. That I am personally acquainted with the mining claim(s). The work and improvements were made by and at the expense of the owner(s) of said claim(s). Said contiguous group of claims, listed on this document, are situated in the

(optional) Mining District; _____ County, Arizona.

Line No.	AMC NUMBER	CLAIM/SITE NAME	COUNTY RECORDER DATA (If available)	TWP	RNG	SEC
1	425-399	CAMPWOOD				
2						
3						
4						
5						
6						

ENTERED
JUN 17 2015
BY: RAM

Form: MCF108
Revised July 2014
Page 1 of 2

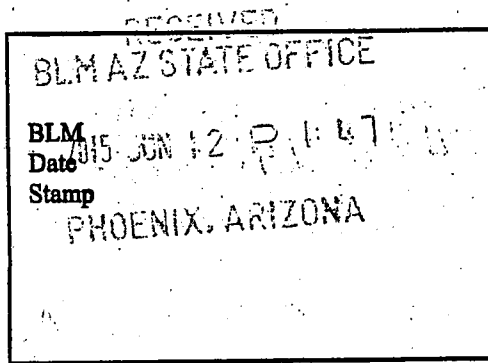

7					
8					
9					
10					

6. That between the dates starting at 12 o'clock noon on September 1, 20 14 and ending at 12 o'clock noon on September 1, 20 15 at least \$ 100.00 dollars worth of work and improvements were done and performed upon said claim(s) or upon one or more of a contiguous group of claims for the benefit of all, wholly or partly outside of a contiguous group of claims for the benefit of all, not including the location work.

7. That the following persons were employed to perform the work and improvements described herein: _____

8. That the work and improvements performed were: GEOLOGICAL, GEOCHEMICAL AND GEOPHYSICAL SURVEYS.

9. Dated: 6/12/15 Signature: Christopher John Keller

SUBSCRIBED AND SWORN TO before me, a Notary Public, this 12th day of June 20 15

By: _____

Notary Public: Amy D. Mocerri

My Commission Expires: June 17th 2016

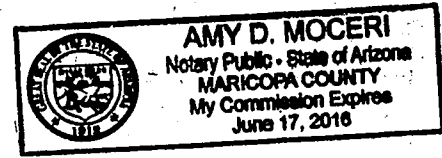

Bureau of Land Management
Arizona State Office
www.blm.gov/az

No. of Claims: 1 x \$10 = 10
 Check No.: Cash Init. YML
 Receipt No.: 3320440
 For BLM Use Only

United States Department of the Interior
Bureau of Land Management
 LANDS/RECREATION & PLANNING
 ONE N CENTRAL AVE
 PHOENIX, AZ 85004 -2203
 Phone: 602-417-9200

Receipt

No: 3320440

Transaction #: 3417703	
Date of Transaction: 06/12/2015	
CUSTOMER:	
CHRISTOPHER KELLER 908 S 17TH AVE PHOENIX, AZ 85007-3508 US	

LINE #	QTY	DESCRIPTION	REMARKS	UNIT PRICE	TOTAL
1	1.00	LOCATABLE MINERALS / MINING CLAIMS- NOT NEW-UNADJUD, ONE AUTH NO. ONLY / MINING CLAIM MONEY RECEIVED CASES: AMC425399/\$10.00	POL 2015/1 WAV	- n/a -	10.00
TOTAL:					\$10.00

PAYMENT INFORMATION					
1	AMOUNT:	10.00	POSTMARKED:	N/A	
	TYPE:	CASH	RECEIVED:	06/12/2015	
	NAME:	KELLER, CHRISTOPHER 908 S 17TH AVE PHOENIX AZ 85007-3508 US			

REMARKS

This receipt was generated by the automated BLM Collections and Billing System and is a paper representation of a portion of the official electronic record contained therein.

ENTERED
 JUN 17 2015
 BY: *Ram*

DEPARTMENT OF THE INTERIOR
BUREAU OF LAND MANAGEMENT
MINING CLAIMS

MC Customer Information - With Serial No. and Claim Name
ACTIVE CLAIMS

Admin State: AZ
Geo State: AZ

KELLER CHRISTOPHER
232 S 12TH AVE
PHOENIX, AZ 85007-3101

CUSTOMER ID: 2354618

<u>Serial No.</u>	<u>Claim Name/Number</u>	<u>Lead Serial No.</u>	<u>Disposition</u>
AMC425399	CAMPWOOD	AMC425399	ACTIVE

Number of ACTIVE cases: 1

UNITED STATES
DEPARTMENT OF THE INTERIOR
BUREAU OF LAND MANAGEMENT

1661

Amc 425399
FORM APPROVED
OMB NO. 1004-0114
Expires: October 31, 2016

MAINTENANCE FEE WAIVER CERTIFICATION

SEE INSTRUCTIONS ON PAGE 2

1/50

- This small miner waiver is filed for the assessment year beginning on September 1, 2014 and ending on September 1, 2015
- The undersigned and all related parties owned ten or fewer mining claims, mill, or tunnel sites located and maintained on Federal lands in the United States of America on September 1, 2014.
- The undersigned have performed the assessment work required by law for each mining claim listed prior to filing this waiver and understand that by filing this form, the undersigned must file an affidavit of assessment work with the Bureau of Land Management (BLM) by the December 30th following the filing of this waiver.
- The undersigned understand that if the assessment work obligation has not yet come due under 30 U.S.C. 28 (for those claims in their first assessment year only), a notice of intent to hold reciting this condition must be recorded by the December 30th following the filing of this waiver.
- The undersigned understand that mill and tunnel sites may also be listed on this waiver and be waived from payment of the maintenance fee, and that a notice of intent to hold for these sites is required to be filed with the BLM by the December 30th following the filing of this waiver.
- The undersigned understand and acknowledge that pursuant to 43 U.S.C. 1212 and 18 U.S.C. 1001, the filing or recording of a false, fictitious, or fraudulent document with the BLM may result in a fine of up to \$250,000, a prison term not to exceed five years, or both.
- The mining claims, mill or tunnel sites for which this waiver from payment of the maintenance fees is requested are:

CLAIM OR SITE NAME	BLM RECORDATION SERIAL NUMBER
1. CAMPWOOD	✓ 425399
2.	
3.	
4.	
5.	
6.	
7.	
8.	
9.	
10.	

The owner(s) (claimants) of the above mining claims and sites are:

CHRISTOPHER JOHN KELLER ✓
 (Owner's Name - Please Print)
 911 SOUTH 17th AVENUE APT. #1
 (Owner's Mailing Address)

Christopher John Keller
 (Owner's Signature)
 PHOENIX ARIZONA 85007
 (City) (State) (Zip Code)

(Owner's Name - Please Print)

(Owner's Signature)

(Owner's Mailing Address)

(City) (State) (Zip Code)

ENTERED
 AC-483
 SEP 16 2014
 PB

(Owner's Name - Please Print)

(Owner's Signature)

(Owner's Mailing Address)

(City) (State) (Zip Code)

(Owner's Name - Please Print)

(Owner's Signature)

(Owner's Mailing Address)

(City) (State) (Zip Code)

(Continued on page 2)

NW CHECKED SEP 22 2014 PB

_____ (Owner's Name - Please Print)	_____ (Owner's Signature)		
_____ (Owner's Mailing Address)	_____ (City)	_____ (State)	_____ (Zip Code)

_____ (Owner's Name - Please Print)	_____ (Owner's Signature)		
_____ (Owner's Mailing Address)	_____ (City)	_____ (State)	_____ (Zip Code)

_____ (Owner's Name - Please Print)	_____ (Owner's Signature)		
_____ (Owner's Mailing Address)	_____ (City)	_____ (State)	_____ (Zip Code)

_____ (Owner's Name - Please Print)	_____ (Owner's Signature)		
_____ (Owner's Mailing Address)	_____ (City)	_____ (State)	_____ (Zip Code)

18 U.S.C. 1001 and 43 U.S.C. 1212 make it a crime for any person knowingly and willfully to make to any department or agency of the United States any false, fictitious or fraudulent statements or representations as to any matter within its jurisdiction.

INSTRUCTIONS

1. This certification is made under the provisions of 43 U.S.C. § 1744 and 30 U.S.C. §28-28k and the regulations thereunder (43 CFR Part 3830).
2. The claimant(s) must fill in the dates in paragraph 1 for the beginning and ending of the assessment year for which this waiver is sought.
3. The claimant(s) must fill in the date in paragraph 2 for the beginning of the assessment year for which this waiver is sought.
4. All claim and site names and BLM serial numbers must be listed for the mining claims, mill sites, and tunnel sites for which the waiver is sought.
5. All owners of the mining claims, mill sites, and tunnel sites and their addresses must be given.
6. This waiver form must be signed by all the claimants or their designated agent, in original form. If an agent is designated, a notarized designation of agent, signed by all of the claimants with proper address given, must be submitted with this waiver.
7. This form must be filed no later than September 1st for the upcoming assessment year in the BLM State Office where the mining claims or sites are recorded, or the waiver cannot be granted by the BLM. (Example: To obtain a waiver for the assessment year 2012, which begins on September 1, 2011, you must qualify for and file for a waiver no later than September 1, 2011, in the proper BLM State Office.)
8. For all mining claims which require assessment work, you must record an affidavit of labor on or before the December 30th immediately following the filing of this waiver. For all other mining claims or sites waived, you must record a notice of intent to hold on or before the December 30th immediately following the filing of this waiver.
9. Mill and tunnel sites may also be listed on this waiver and be waived from payment of the maintenance fee. A notice of intent to hold for these sites is required to be filed by the December 30th following the filing of this waiver.

FOR OFFICIAL USE ONLY

RECEIVED
BLM AZ STATE OFFICE
2014 SEP - 2 1:46
PHOENIX, ARIZONA

425399

When Recorded Return Document to:

CHRISTOPHER JOHN KELLER
911 SOUTH 17th AVENUE #1
PHOENIX, ARIZONA 85007

Check here if this is a change of address.

Telephone: _____

E-mail address: _____

AFFIDAVIT OF PERFORMANCE OF ANNUAL WORK

1. State of Arizona, County of MARICOPA ss:

2. I (Name) CHRISTOPHER JOHN KELLER

3. Reside at (Address) 911 SOUTH 17th AVENUE
APT. #1

City PHOENIX County MARICOPA

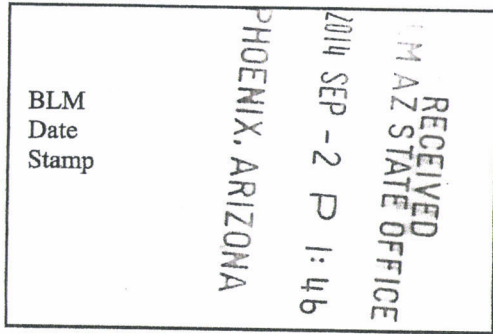

State AZ Zip 85007 being duly sworn, depose and say that I am a citizen of the United States, more than eighteen years of age, and that all of the facts set forth in this affidavit, subject to the provisions and penalties of 18 U.S.C. 1001 pertaining to the filing of false, fictitious, or fraudulent statements with the United States, are true and correct according to the best of my knowledge, information and belief.

4. Owner's name and address (If not shown in Items 1-3 above). _____

5. That I am personally acquainted with the mining claim(s). The work and improvements were made by and at the expense of the owner(s) of said claim(s). Said contiguous group of claims, listed on this document, are situated in the

_____ (optional) Mining District; _____ County, Arizona.

Line No.	AMC NUMBER	CLAIM/SITE NAME	COUNTY RECORDER DATA (If available)	TWP	RNG	SEC
1	425399	CAMPWOOD				
2						
3						
4						
5						
6						

ENTERED
SEP 03 2014
BY: RAM

BLM
Date
Stamp

2014 SEP - 2 P
1:46
PHOENIX, ARIZONA

RECEIVED
BLM AZ STATE OFFICE

7					
8					
9					
10					

6. That between the dates starting at 12 o'clock noon on September 1, 20~~13~~¹⁴ and ending at 12 o'clock noon on September 1, 20~~14~~¹⁴ at least \$ 100⁰⁰ dollars worth of work and improvements were done and performed upon said claim(s) or upon one or more of a contiguous group of claims for the benefit of all, wholly or partly outside of a contiguous group of claims for the benefit of all, not including the location work.

7. That the following persons were employed to perform the work and improvements described herein: MYSELF (CHRISTOPHER JOHN KELLER)

8. That the work and improvements performed were: PLACER MINING OF FREE GOLD IN LOOSE GRAVEL AND BROWN DIRT MIXED WITH PINK QUARTZ.

9. Dated: 9/2/14 Signature: [Signature]
 SUBSCRIBED AND SWORN TO before me, a Notary Public, this 2 day of September 2014

By: Alex Kopchynski
 Notary Public [Signature]
 My Commission Expires 1/24/2018

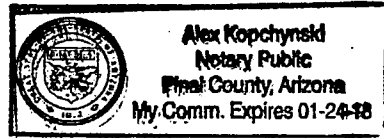

No. of Claims: 1 x \$10 = 10
 Check No.: CASH Init. SC
 Receipt No.: 3120049
 For BLM Use Only

Bureau of Land Management
 Arizona State Office
www.blm.gov/az

United States Department of the Interior
Bureau of Land Management
 LANDS/RECREATION & PLANNING
 ONE N CENTRAL AVE
 PHOENIX, AZ 85004 -2203
 Phone: 602-417-9200

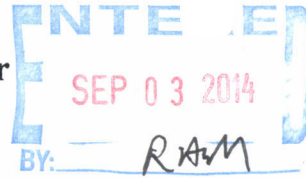

Receipt

No: 3120049

Transaction #: 3211876	
Date of Transaction: 09/02/2014	
CUSTOMER:	
CHRISTOPHER KELLER 911 S 17TH AVE PHOENIX,AZ 85007-3507 US	

LINE #	QTY	DESCRIPTION	REMARKS	UNIT PRICE	TOTAL
1	1.00	LOCATABLE MINERALS / MINING CLAIMS- NOT NEW-UNADJUD,ONE AUTH NO. ONLY / MINING CLAIM MONEY RECEIVED CASES: AMC425399/\$10.00	WAIVER 2015 POL 2014 (1)	- n/a -	10.00
TOTAL:					\$10.00

PAYMENT INFORMATION					
1	AMOUNT:	10.00	POSTMARKED:	N/A	
	TYPE:	CASH	RECEIVED:	09/02/2014	
	NAME:	KELLER, CHRISTOPHER 911 S 17TH AVE PHOENIX AZ 85007-3507 US			

REMARKS

This receipt was generated by the automated BLM Collections and Billing System and is a paper representation of a portion of the official electronic record contained therein.

NOTICE!!

These documents have been scanned!

Do not place un-scanned documents beneath this notice!

Do not remove this notice from this file!

GPO Jacket No. 560-102
Print Order 61540
Rise Business Services, LLC
Job=AZ15 5/10/2019



Box Number= AZ15036



Claim Begin-End: AMC425399-AMC425399

6 Location Notices-Amendments and Supporting Documents



AZ15036-16

AMC425096-AMC425592

**DEPARTMENT OF THE INTERIOR
BUREAU OF LAND MANAGEMENT
MINING CLAIMS**

Run Date/Time: 11/22/2013 01:51 PM

(LIVE) Serial Register Page

Page 1 of 1

01 10-21-1976;090STAT0090;43USC1744
Case Type 384201: PLACER CLAIM
Claim Name: CAMPWOOD
Commodity :
Case Disposition: ACTIVE
Required Maintenance Fee: \$140.00

Total Acres
20.000

Serial Number
AMC425399
Lead File Number
AMC425399

Name & Address	Int Rel
KELLER CHRISTOPHER 911 S 17TH AVE # 1 PHOENIX, AZ 85007-3507	CLAIMANT

Mer Twp Rng Sec Quadrant District/Field Office County
14 0060N 0050E 025 NE HASSAYAMPA FO MARICOPA

Act Date	Code	Action	Action Remarks	Receipt Number
11/10/2013	403	LOCATION DATE		
11/12/2013	395	RECORDATION NOTICE RECD	1	2908756
11/12/2013	484	LOCATION YEAR / MAINTENANC	2014;\$140	2908756
11/12/2013	501	ACCT ADV IN LEAD FILE	AMC425399;	

Line Nr Remarks

MINING CLAIM STATUS REPORT

DATA ENTERED 11/18/2013

MTP Checked by NCH 11/12/13
GEO Checked by NCH

LEAD SERIAL NUMBER AMC 425399 thru AMC _____

# OF CLAIMS & TYPE	CHARGES
# _____ LODE	Location Fee @ \$34 = \$ <u>34</u>
# <u>1</u> PLACER	Processing Fee @ \$15 = \$ <u>20</u>
# _____ ASSOCIATION PLACER	Maintenance Fee @ \$140 = \$ <u>140</u>
# _____ MILL SITE	Overage (+) \$ _____
# _____ TUNNEL SITE	Shortage (-) \$ _____
	Other Fees \$ _____
	TOTAL \$ <u>194</u>

TOTAL CLAIM ACREAGE? 20

OF LOCATORS? 1

DOCUMENTS RECEIVED VIA - Over-the-Counter () Mail ()

TIMELY FILED? Yes () No ()

LEGAL DESCRIPTION - T 6N R 5E SEC 25

T _____ R _____ SEC _____

T _____ R _____ SEC _____

T _____ R _____ SEC _____

BLM () FOREST SERVICE () Tonto SUBJ TO PL 359: Yes () No ()

WILDERNESS AREA: No () Yes () _____

SPLIT ESTATE - N/A () SX () PX () SRHA () OTHER () _____

Proper Notice Filed if Located on SHRA Lands? N/A () Yes () No ()

RECONVEYED MINERALS ON BLM LANDS REQUIRE OPENING ORDERS FROM 1944 TO 1993 -

Open to Entry on: _____ N/A ()

COMMENTS/STATUS - VOID () PARTIALLY VOID () PVT MINERALS () WITHDRAWN LANDS ()

OTHER () _____

ARCH 55399

Claimant acknowledges that portions of the following claims(s) site(s) may be void or voidable.

Printed Name of Claimant _____ Signature of Claimant _____

***** FINAL ADJUDICATION *****

DATE 5/7/14 INITIALS AT

LOCATION NOTICE FOR PLACER MINING CLAIM

NOTICE IS HEREBY GIVEN that the CAMP WOOD
(20 ACRES) placer mining claim has been located by
CHRISTOPHER KELLER whose current mailing
address is 911 SOUTH 17TH AVE #1
PHOENIX, ARIZONA 85007

RECEIVED
BLM AZ STATE OFFICE
2013 NOV 12 A 9:30
PHOENIX, AZ
BLM
Date
Stamp

The general course of this claim is WEST TO EAST and it is situated in
MARICOPA County, Arizona.

This claim is 1320 feet in length and 660 feet in width. This claim runs from the
location monument on which this location notice is posted approximately 70 feet in a WEST
direction to the EAST end line and 125 feet in a NORTH direction to the SOUTH end line.

This claim is marked by four monuments, one at each corner of the claim.

The location monument on which this notice is posted is situated within Section 25, Township
6 N, Range 5 E, Gila Salt River Base and Meridian, Arizona. This claim encompasses
portions of the following legal subdivision(s) if located by legal subdivision or the following quarter section (s),
section (s), Township (s) and Range (s) N 1/2, NE 1/4, NE 1/4 SEC 25
T6N, R5E, Gila Salt River Base and Meridian, Arizona.

The locality of this claim with reference to some natural object or permanent monument and additional
information (if any) concerning its locality are as follows: 2000 FT SOUTH OF
BARTLETT DAM ROAD, WEST OF CAMP
CREEK, SECTION 25.

DATED AND POSTED on the ground this 10 day of NOV, 20 13
LOCATOR (s) CHRISTOPHER KELLER

Form MCF102
Revised July 2005

This form is available from the Arizona Department of Mines & Mineral Resources and may be reproduced.

ENTERED
NOV 22 2013
BY: fm

ALIC1195399

MINING CLAIM MAP

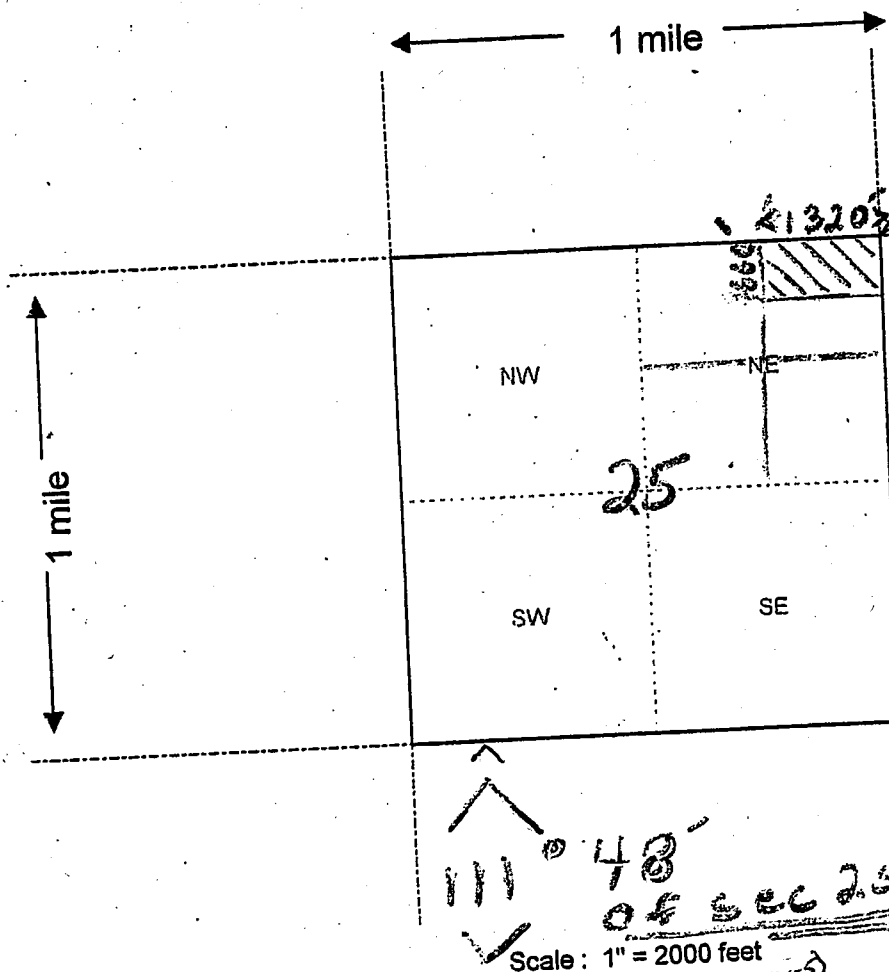

Lode () Placer (✓)
 T6N
 R5E S24/S19 R6E
 S25/S30
 U.S. MARKER
 BUR. OF LAND MANAGEMENT
 1963

33° 50'
 of S 1320'
 PHOENIX, AZ
 RECEIVED
 AZ STATE OFFICE
 NOV 12 A 9:30

AH0425399

111° 48'
 of sec 25
 Scale: 1" = 2000 feet

1. The above map depicts the CAMPWOOD (20 acres) mining claim, which is located in Section (s) 25, Township 6 N, Range 5 E, Gila and Salt River Base and Meridian, MARICOPA County, Arizona.

2. The type of corner and location monuments used are as follows: TEMPORARY ALUMINUM TAB; HANGING FROM BRANCHES, LOCATION MONUMENT WITH PLASTIC BOTTLE.

3. The bearings and distances in degrees and feet between claim corners are as depicted on the map.
1320' x 660' ONLY.

Form MCF100a
 Revised July 2005

This form is available from the Arizona Department of Mines & Mineral Resources and may be reproduced.

RUN TIME: 09:11 AM

DEPARTMENT OF INTERIOR
BUREAU OF LAND MANAGEMENT

RUN DATE: 11/12/2013

Input Parameters for Geographic Report with Land

System Id = CR

Admin State = AZ

Geo State =

Casetype =

Casetype Txt =

Case Disp Txt = AUTHORIZED, CANCELLED, EXPIRED, PENDING, REJECTED, RELINQUISHED, VOID, WITHDRAWN

Mer Twp Rng =

Mtrs = 14 0060N 0050E 025, 14 0060N 0050E 999

Commodity =

Commodity Txt =

Adm Agency Begins With

Total Rows Returned: 0

NO WARRANTY IS MADE BY BLM FOR USE OF THE DATA
FOR PURPOSES NOT INTENDED BY BLM

